

1

2

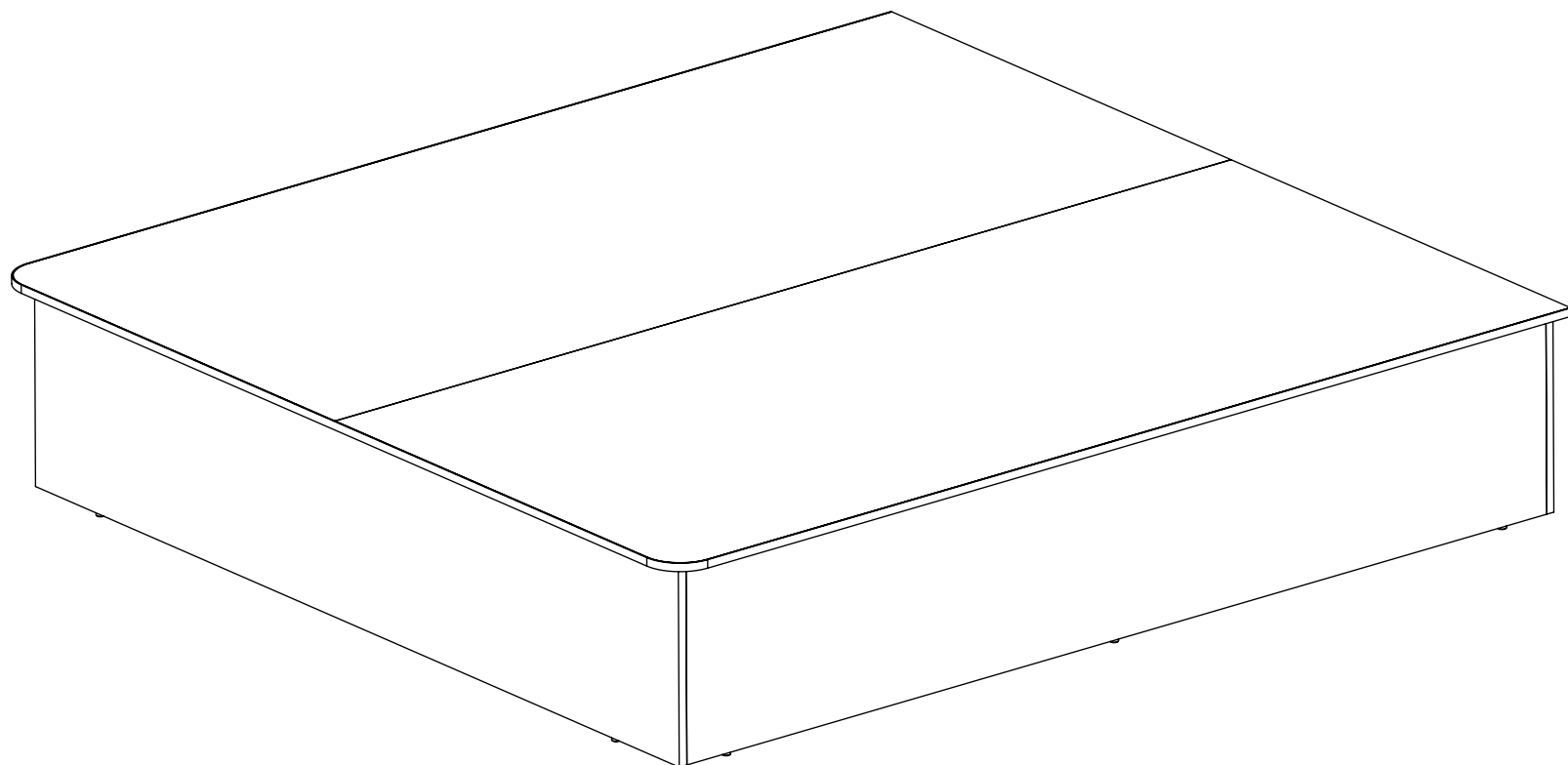

A

A

B

B

**Overall:**  
75"W x 80"D x 16"H

**MATERIALS:**

- HP-Laminate PLY-5/8" Side Panels
- Plywood 5/8" Top Panel
- T-Mold Edge On Top
- Nail Glide On Bottom
- Wood Framing Support

**COMMENTS:**

- Overall: 75"W x 80"D x 16"H
- Color: Wilsonart - 0000 - Custom Laminate
- Note: Dimensional Tolerance +/- 1/16"

**TITLE:** AHF 0100XX 6BB - 100Sable - King Bed Base 2" Lip  
**REVISION DATE:** 4/7/2022

NOTE: DESIGN AND DRAWINGS ARE PROPERTY OF DICKSON FURNITURE MANUFACTURERS LLC AND MAY NOT BE DUPLICATED OR REPRODUCED WITHOUT THE EXPRESS WRITTEN CONSENT OF DICKSON FURNITURE MANUFACTURERS LLC

|                          |    |
|--------------------------|----|
| QUANTITY                 | 00 |
| REV                      | A  |
| DIMENSIONS ARE IN INCHES |    |

**DICKSON**  
FURNITURE MANUFACTURERS

SCALE: 1:13  
SHEET 1 OF 5

1

2

1

2

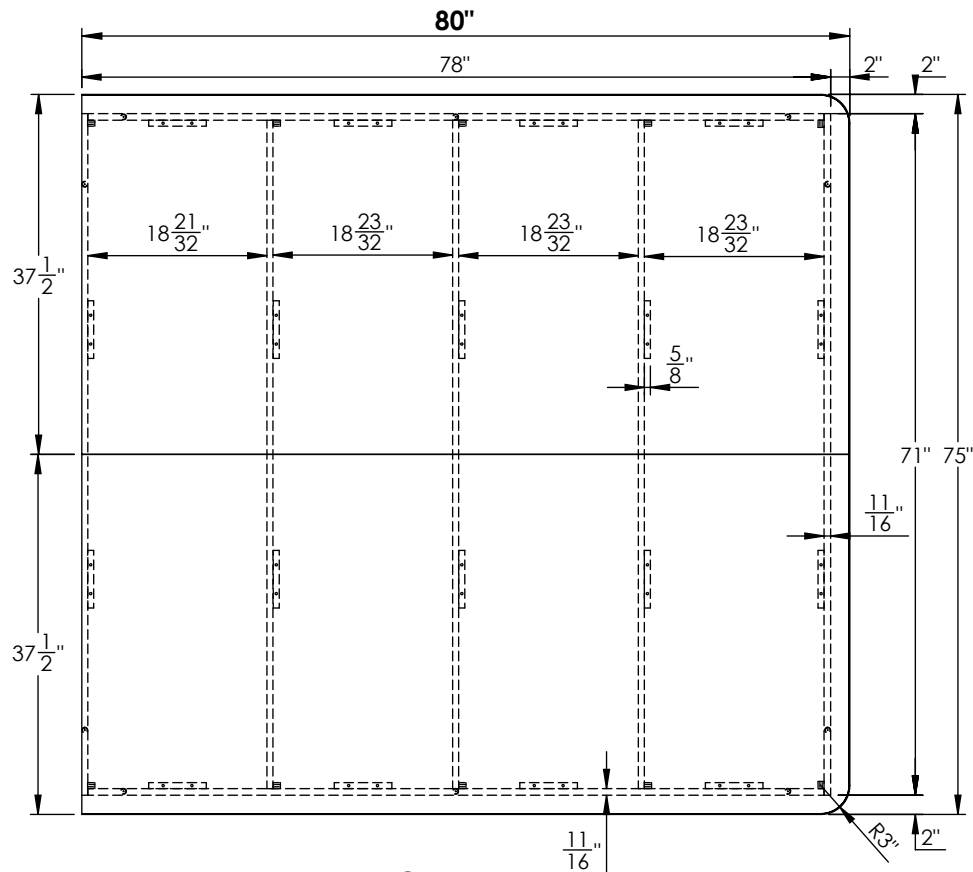

TOP VIEW

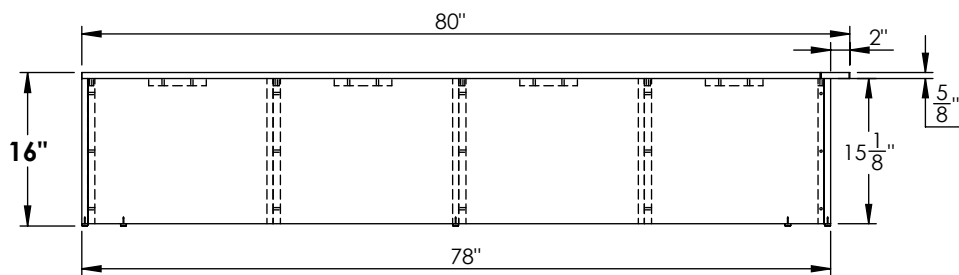

FRONT ELEVATION

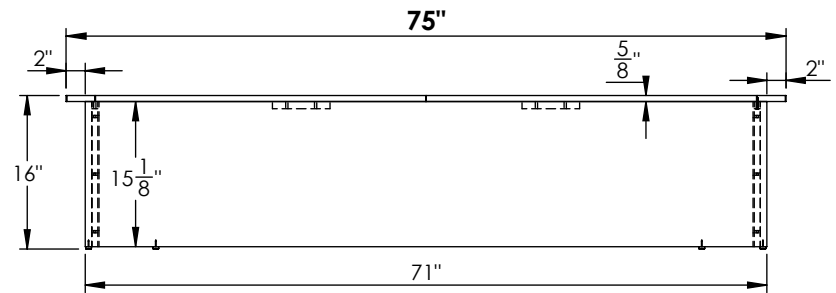

SIDE VIEW

- MATERIALS:
- HP-Laminate PLY-5/8" Side Panels
  - Plywood 5/8" Top Panel
  - T-Mold Edge On Top
  - Nail Glide On Bottom
  - Wood Framing Support

- COMMENTS:
- Overall: 75"W x 80"D x 16"H
  - Color: Wilsonart - 0000 - Custom Laminate
  - Note: Dimensional Tolerance +/- 1/16"

TITLE: AHF 0100XX 6BB - 100Sable - King Bed Base 2" Lip  
 REVISION DATE: 4/7/2022

NOTE: DESIGN AND DRAWINGS ARE PROPERTY OF DICKSON FURNITURE MANUFACTURERS LLC AND MAY NOT BE DUPLICATED OR REPRODUCED WITHOUT THE EXPRESS WRITTEN CONSENT OF DICKSON FURNITURE MANUFACTURERS LLC

|                          |   |
|--------------------------|---|
| QUANTITY<br><b>00</b>    | <b>DICKSON</b><br>FURNITURE MANUFACTURERS |
|                          |   |
| REV<br><b>A</b>          | SHEET 2 OF 5                              |
| DIMENSIONS ARE IN INCHES |   |

1

2

A

A

B

B



# IMPORTANT INFORMATION

- AHF 0100XX 6BB - 100Sable - King Bed Base 2" Lip -



Lift parts with at least 2 people

## +RECOMMENDATIONS:

- Read instructions before installing
- Keep area clean
- Do not drag the parts
- Do not forget to wear PPE

## +PERSONAL PROTECTION EQUIPMENT (PPE)

- Hand Protection
- Eye Protection
- Waist Support Belt

## Parts:

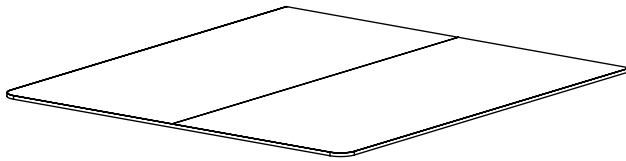

Top Panels

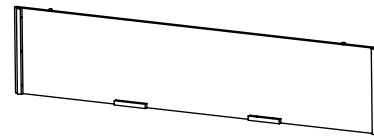

Front Panel

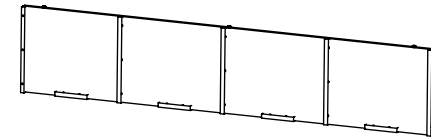

Side Panels (2)

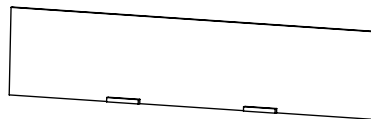

Center Panels (3)

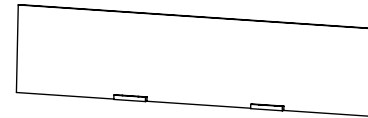

Back Panel

## +Tools:



Measuring Tape



Pencil



Electric screwdriver

## +Hardware:



Screw

# DICKSON

FURNITURE MANUFACTURERS

# STEP #1

# ASSEMBLY INSTRUCTIONS

- AHF 0100XX 6BB - 100Sable - King Bed Base 2" Lip -

Note: For best results, bed should be built starting with the top side face down.

**1**

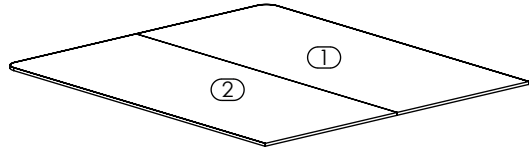

Place Top Panels ② ① upside down on Floor.

**2**

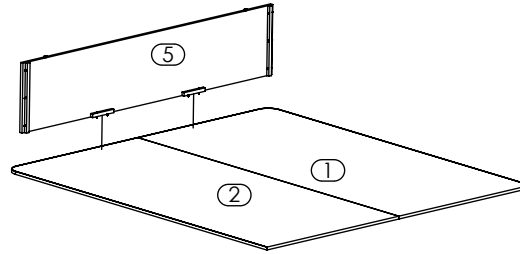

Place Front Panel ⑤ on Top Panels ① ②.

**3**

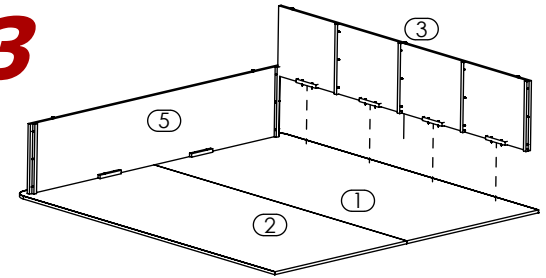

Place Side Panel Right ③ on Top Panels ① ②.

**4**

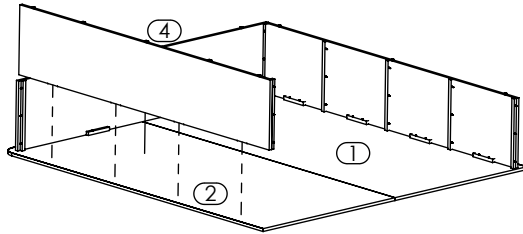

Place Side Panel Left ④ on Top Panel ① ②.

**5**

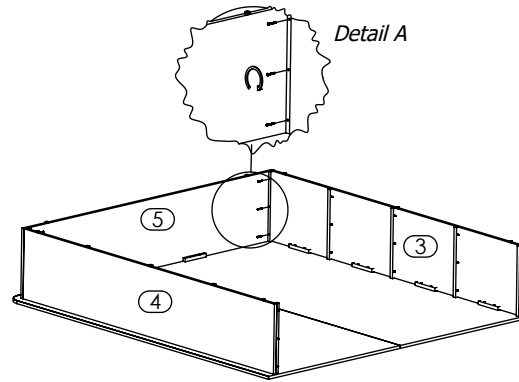

Align and attach Front Panel ⑤ to Side Panel Right ③ then Panel Left ④. (Reference Detail A).

**6**

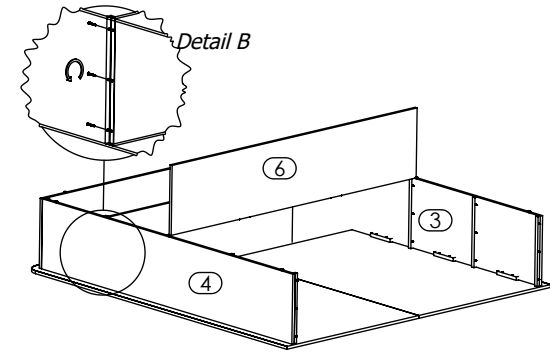

Insert Center Panels ⑥, align & attach to Side Panels ③ ④. (Reference Detail B).

**7**

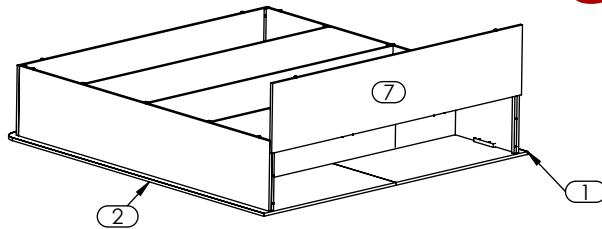

Align Flush the Back Face of Back Panel ⑦ and Top Panels ① ②.

**8**

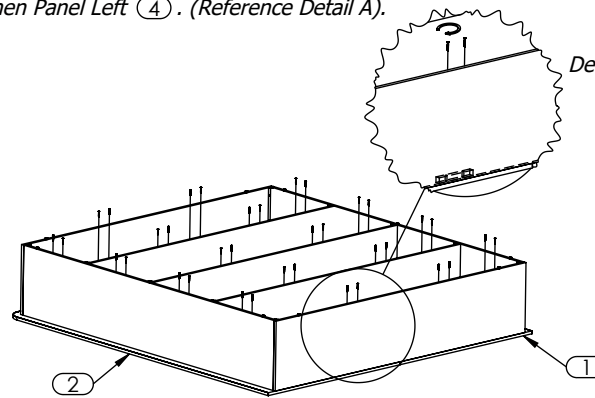

Align assembled Bed Base to taped guides on Top Panel ① and attach them. (Reference Detail C).

# DICKSON

FURNITURE MANUFACTURERS

# STEP #2

Note: To flip this bed, please use at least 2 people.

# ASSEMBLY INSTRUCTIONS

- AHF 0100XX 6BB - 100Sable - King Bed Base 2" Lip -

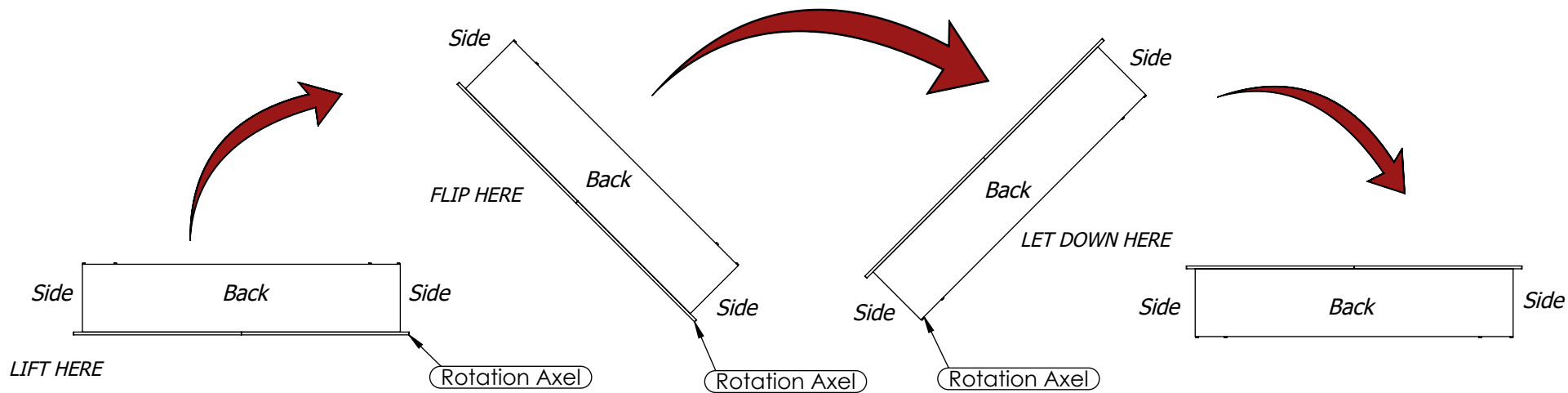

## Flip Upright

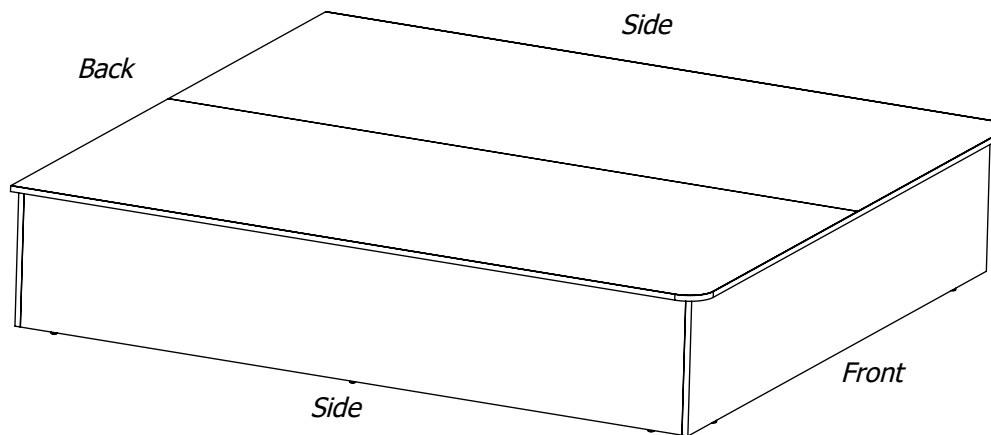

# DICKSON

FURNITURE MANUFACTURERS